

ECO Push-pull handles

Product information

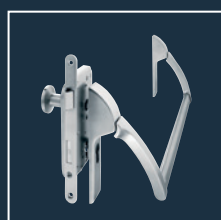

■ SYSTEM TECHNOLOGY FOR THE DOOR

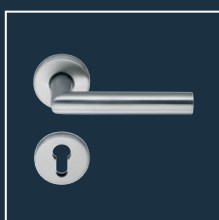
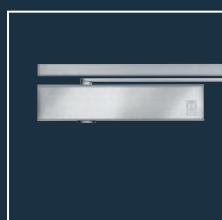

Push-pull handles



S-110 Push-pull handle straight

Handle diameter 32 mm. Distance between centres 300 mm. Simple and fast mounting. Single-sided or double-sided fastening possible.

Note: Further centre distances on request.

The accessory for the single-sided fastening has to be ordered separately.



Execution	Single-sided without fixing material	Double-sided incl. fixing material
Article number	255611.46	255621.46

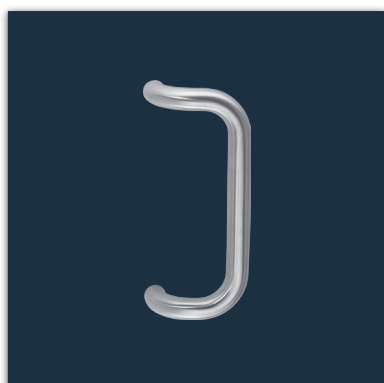
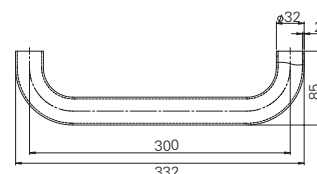

S-410 Push-pull handle cranked

Handle diameter 32 mm. Distance between centres 300 mm. Simple and fast mounting. Single-sided or double-sided fastening possible.

Note: Further centre distances on request.

The accessory for the single-sided fastening has to be ordered separately.



Execution	Single-sided without fixing material	Double-sided incl. fixing material
Article number	255614.46	255624.46

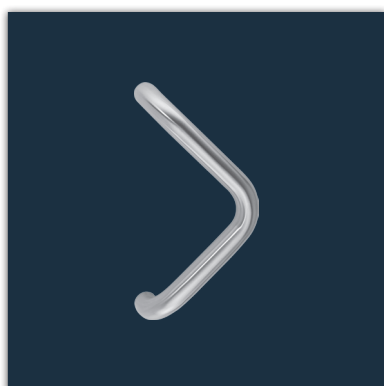
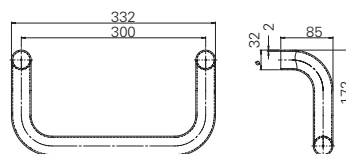

S-210 Push-pull handle triangular

Handle diameter 32 mm. Distance between centres 300 mm. Simple and fast mounting. Single-sided or double-sided fastening possible.

Note: Further centre distances on request.

The accessory for the single-sided fastening has to be ordered separately.



Execution	Single-sided without fixing material	Double-sided incl. fixing material
Article number	255613.46	255623.46

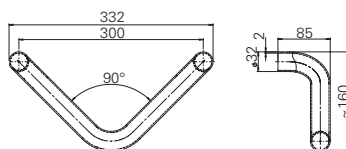

S-510 Push-pull handle semi-circular

Handle diameter 32 mm. Distance between centres 210 mm. Simple and fast mounting. Single-sided or double-sided fastening possible.

Note: Further centre distances on request.

The accessory for the single-sided fastening has to be ordered separately.



Execution	Single-sided without fixing material	Double-sided incl. fixing material
Article number	255612.46	255622.46

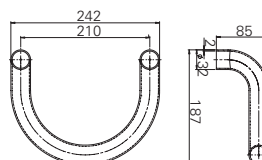

Push-pull handles



S-330 Push-pull handle short

Handle diameter 32 mm. Distance between centres 210 mm. Total length 330 mm.
Simple and fast mounting.
For single-sided fastening.

The fixing set is independent from the door width and has to be ordered separately.

Fixing set for wooden doors:

Article number: 10916252

Fixing set for steel and profile frame doors:

Article number: 10916251



Article number 102557034600080

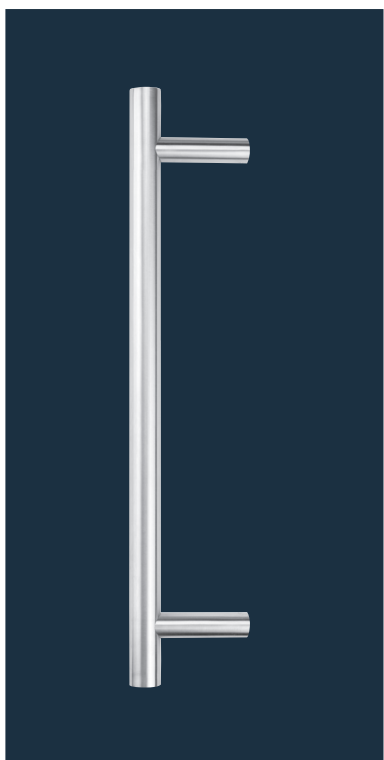
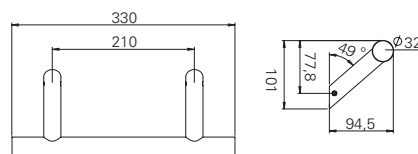

S-310 Push-pull handle long

Handle diameter 32 mm. Distance between centres 600 mm. Total length 1.000 mm.
Simple and fast mounting.
For single-sided fastening.

The fixing set is independent from the door width and has to be ordered separately.

Fixing set for wooden doors:

Article number: 10916252

Fixing set for steel and profile frame doors:

Article number: 10916251



Article number 102557014600080

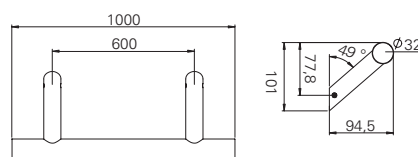

Fixing solutions for push-pull handles



Fixing solution 1 for push-pull handles

Single-sided fixing with rose for door thickness 50 – 80 mm.

Fixing solution 2 for push-pull handles

Double-sided fixing with rose for screw-on fastening for door thickness 10 - 40 mm / 40 - 80 mm.

Invisible screwing, accessory set without illustration.

Execution	Fixing solution 1 for push-pull handles	Fixing solution 2 for push-pull handles
Article number	255601	255600

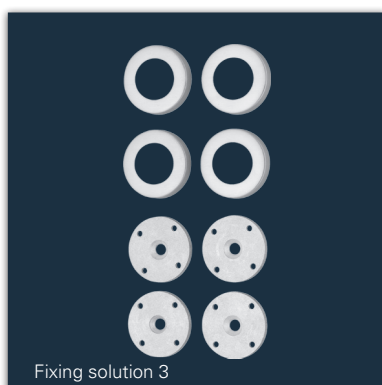

Fixing solution 3 for push-pull handles

Double-sided fixing with rose for screw-on fastening.

Execution	Fixing solutions 3 for push-pull handles
Article number	255602

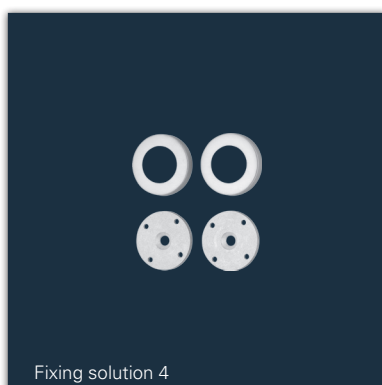

Fixing solution 4 for push-pull handles

Single-sided fixing with rose.

Execution	Fixing solutions 4 for push-pull handles
Article number	255603



Fixing solution 5 for push-pull handles

Single-sided fixing for hollow profiles.

Execution	Fixing solutions 5 for push-pull handles
Article number	255808

Fixing solutions for push-pull handles S-330 / S-310



Fixing screws for push-pull handles S-330 / S-310

Wooden doors

(2 screws)

Winding: 8 mm x 27 mm

Execution	Fixing screws S-330 / S-310 for push-pull handles / Wooden doors
Article number	10916252

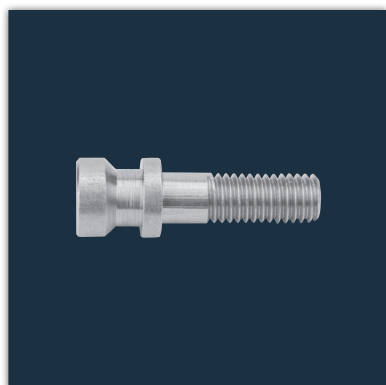

Fixing screws for push-pull handles S-330 / S-310

Steel and profile frame doors

(If necessary use pop rivet nut)

(2 screws)

Winding: M8 x 25 mm

Execution	Fixing screws S-330 / S-310 for push-pull handles / Steel and profile frame doors
Article number	10916251

ECO Schulte GmbH & Co. KG
Iserlohner Landstraße 89
D-58706 Menden

Telefon: +49 2373/92 76-0
Fax: +49 2373/92 76-40

info@eco-schulte.de
www.eco-schulte.de

© ECO Schulte GmbH & Co. KG - Änderungen vorbehalten
© ECO Schulte GmbH & Co. KG - Subject to change