

120 +/-1

428,5

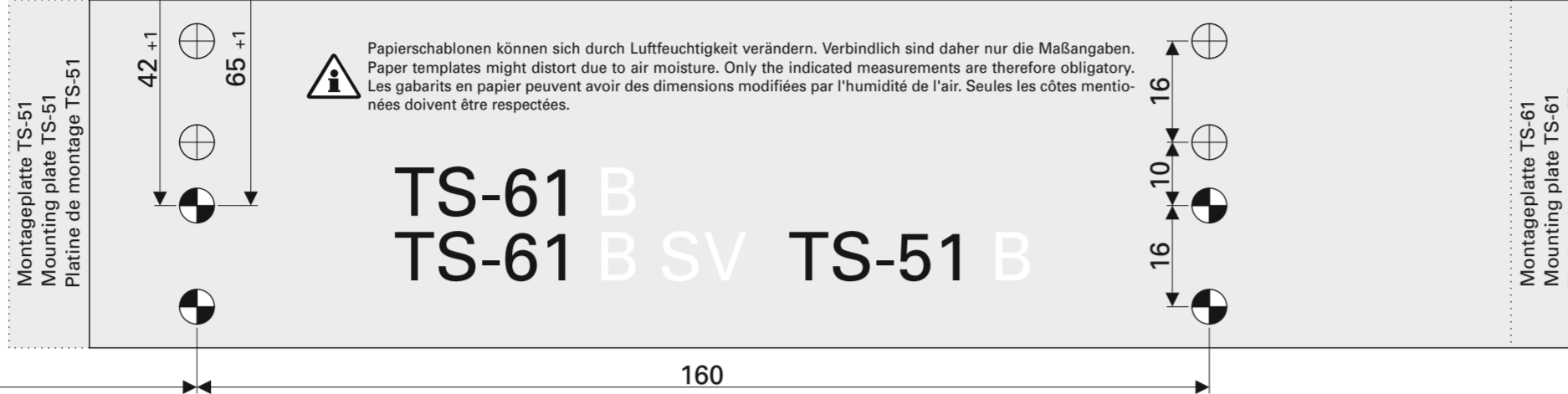
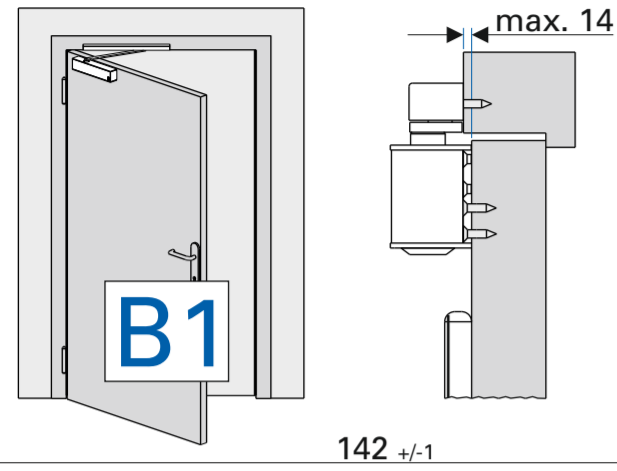

Lochgruppe gemäß Beiblatt 1 zur DIN EN 1154

Drillings according to supplemental sheet 1 DIN EN 1154

Alésage selon supplément 1 DIN EN 1154

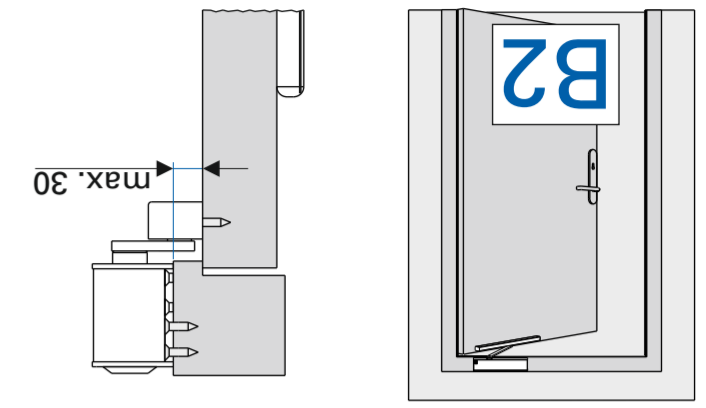

TS-61 B

EN 2-5 / 5-6

TS-61 B SV

EN 2-5 / 5-6

TS-51 B

EN 1-4



CE	ECO Schulte GmbH & Co. KG Iserlohner Landstraße 117 D-58706 Menden	06
0432 - CPD - 0031	EN 1154:1996+A1:2002 / AC:2006	
	4 8	1-4 1 1 3
	4 8	2-5 1 1 4
	4 8	5-6 1 1 4

Türschließergröße Door closer size Force de ferme porte	Max. Türbreite Max. door width Largeur de porte max.	Umdrehungen Rotations Rotations
TS-51 B EN 1-4		
■1	750 mm	-7
■2	850 mm	-4
■3	950 mm	0
■4	1100 mm	+6

Türschließergröße Door closer size Force de ferme porte	Max. Türbreite Max. door width Largeur de porte max.	Umdrehungen Rotations Rotations
TS-61 B TS-61 B SV EN 2-5		
■2	850 mm	-5
■3	950 mm	0
■4	1100 mm	+7
■5	1250 mm	+15

Türschließergröße Door closer size Force de ferme porte	Max. Türbreite Max. door width Largeur de porte max.	Umdrehungen Rotations Rotations
TS-61 B TS-61 B SV EN 5-6		
■5	1250 mm	0
■6	1400 mm	+6

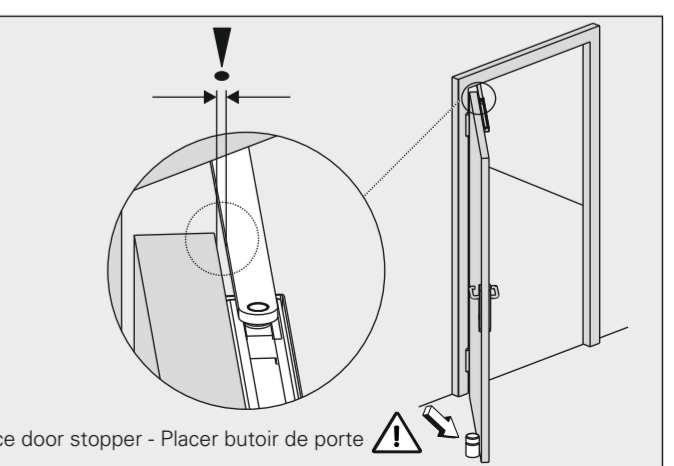
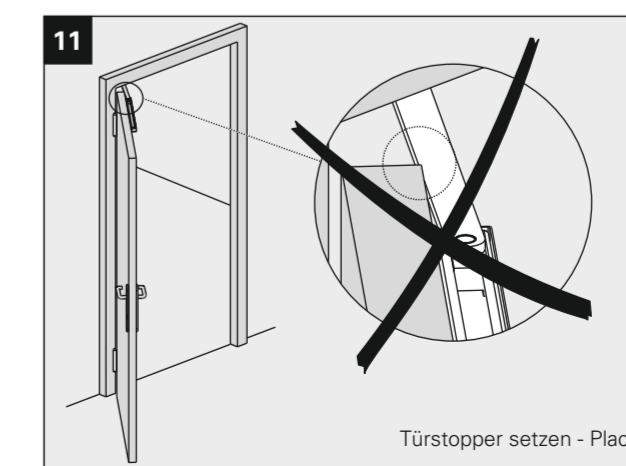
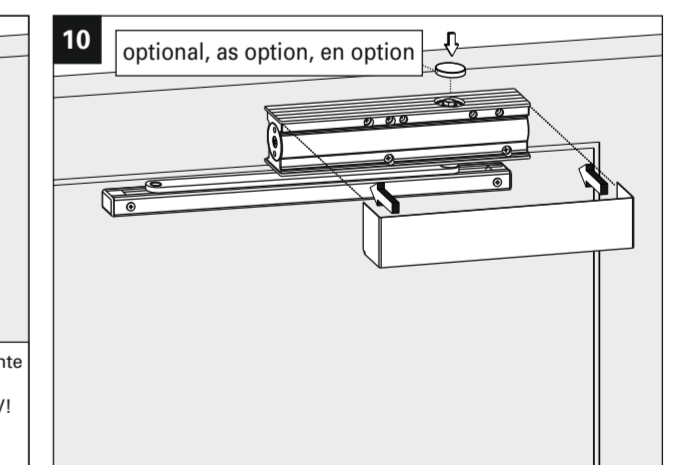
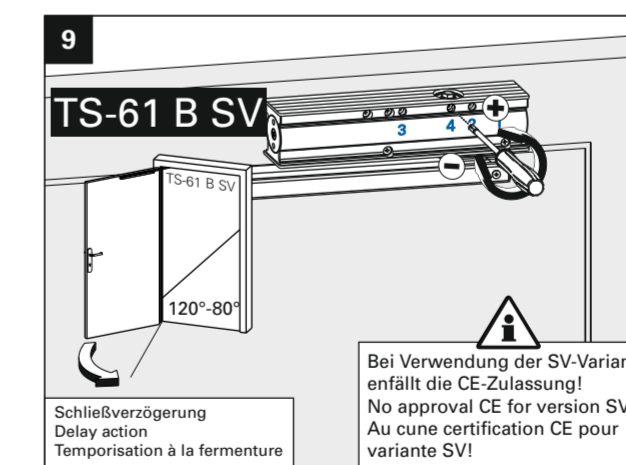
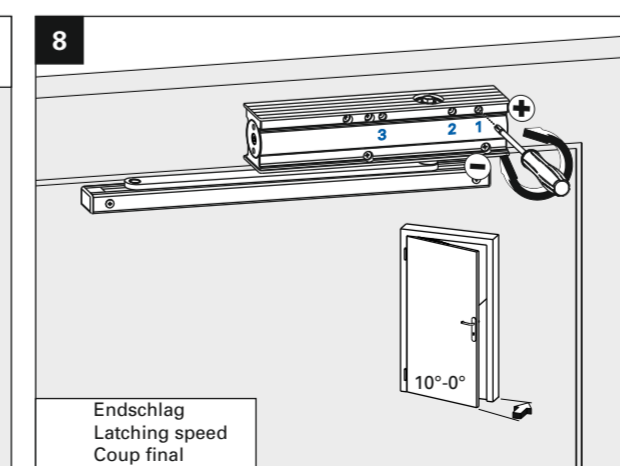
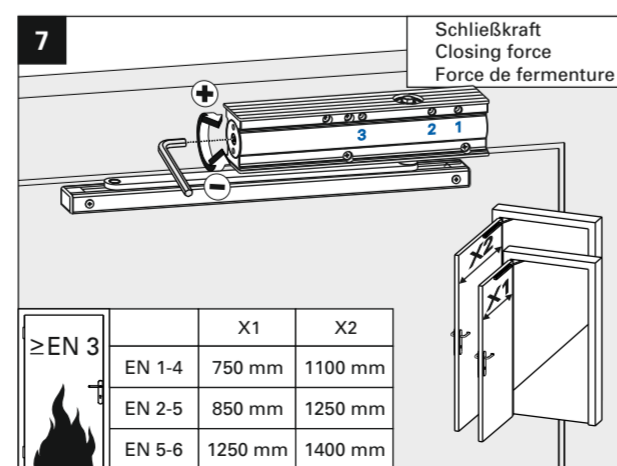
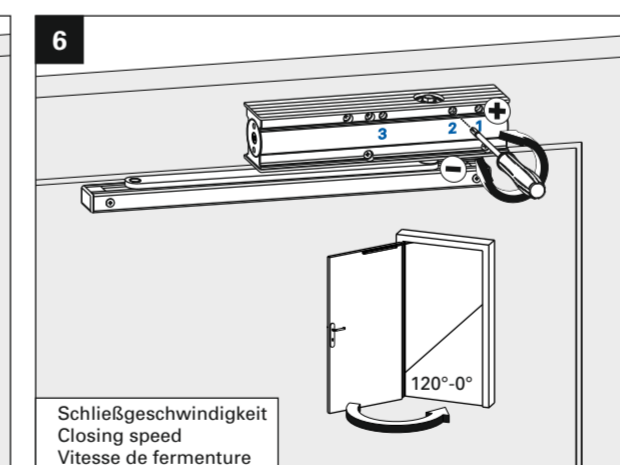
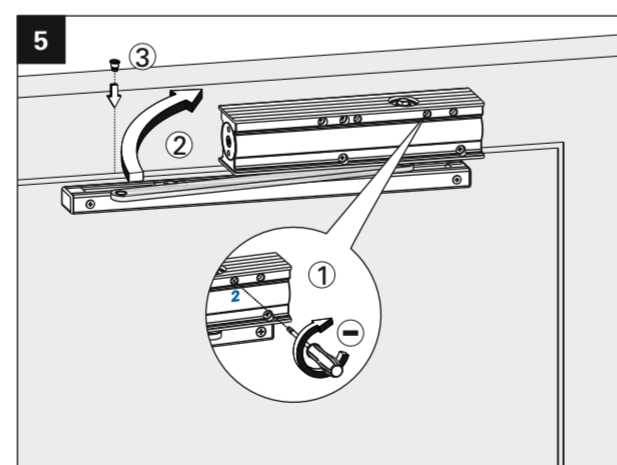
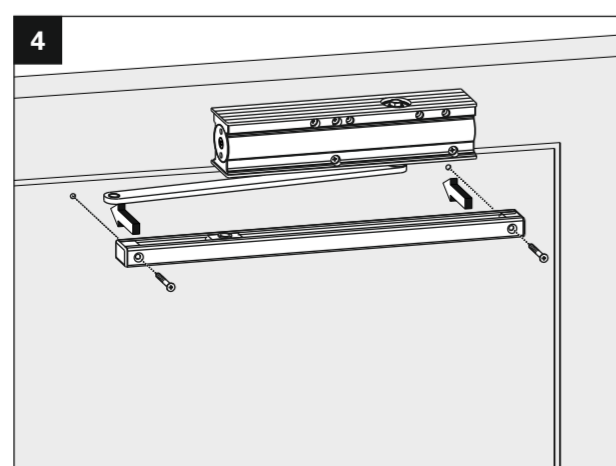
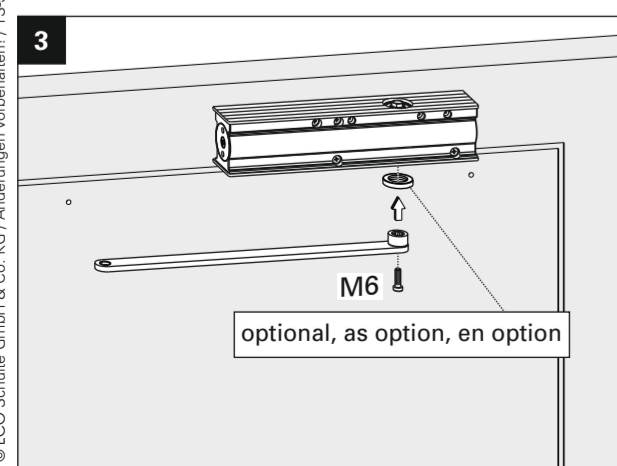
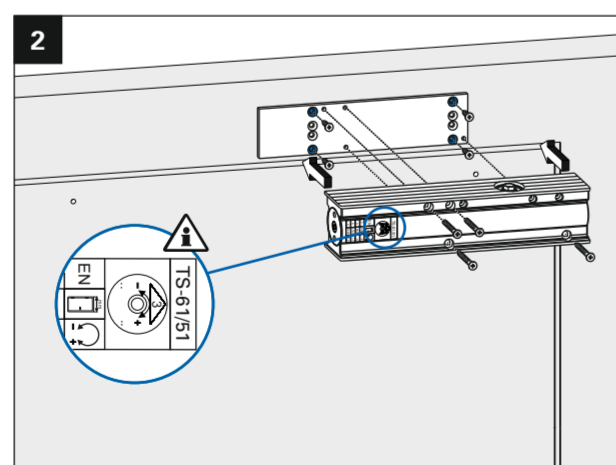
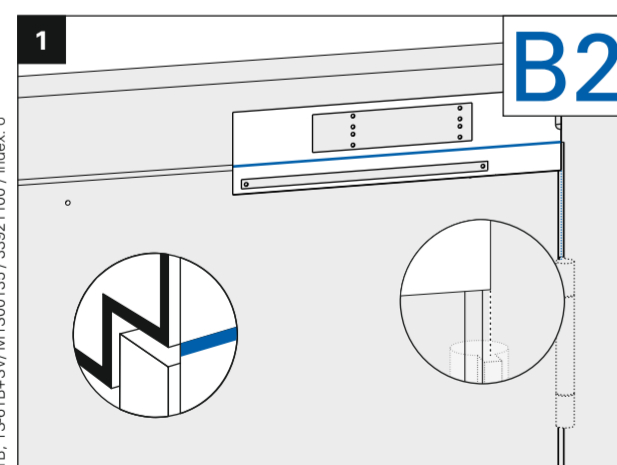
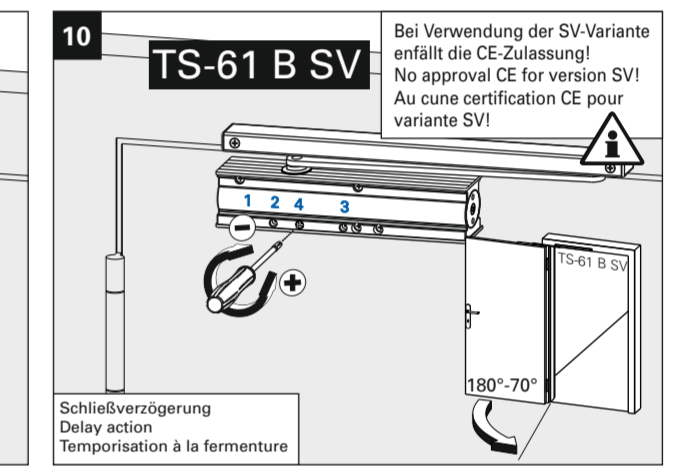
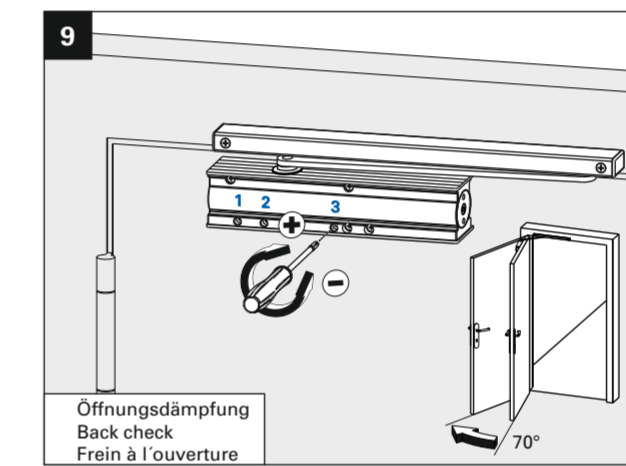
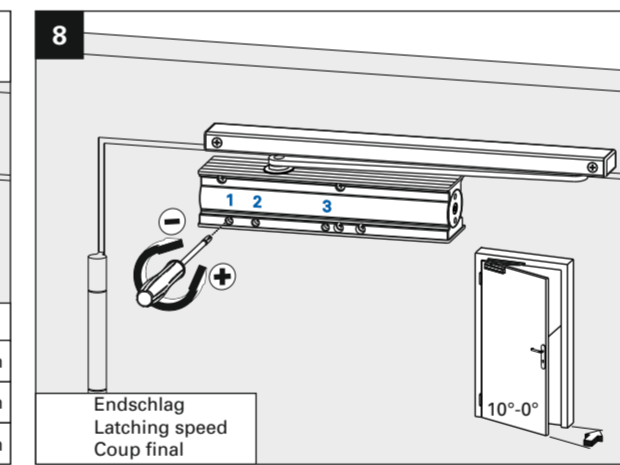
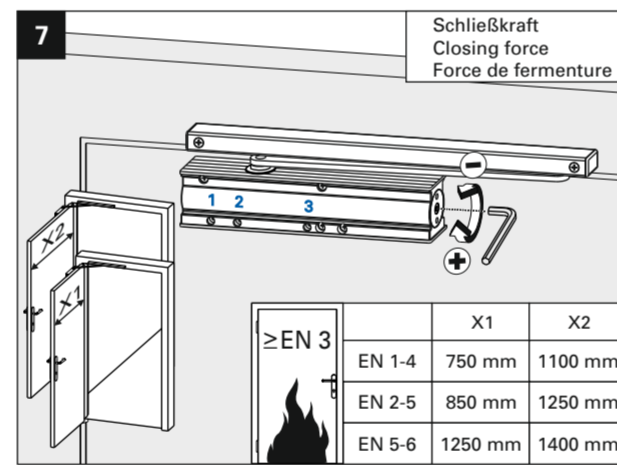
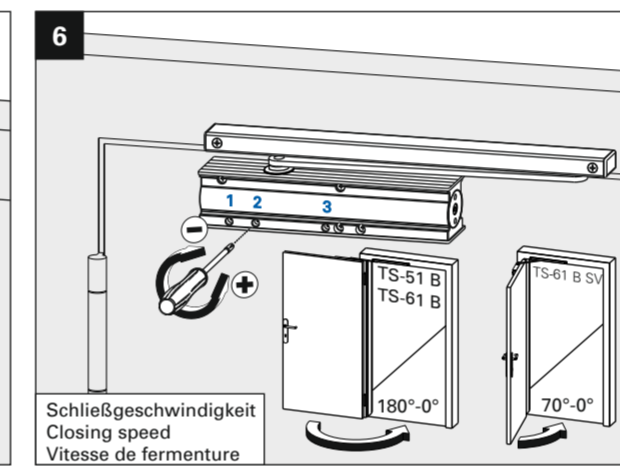
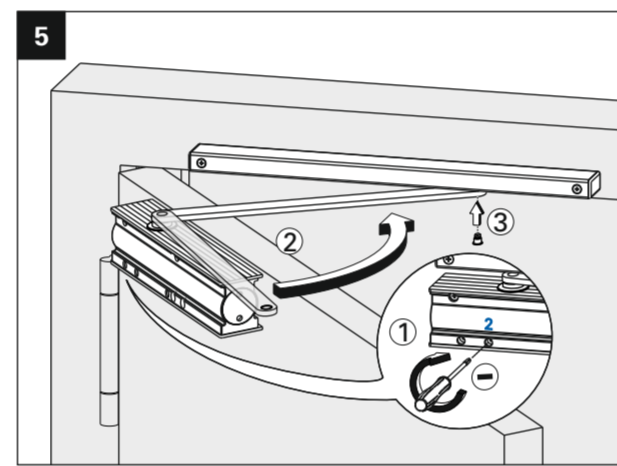
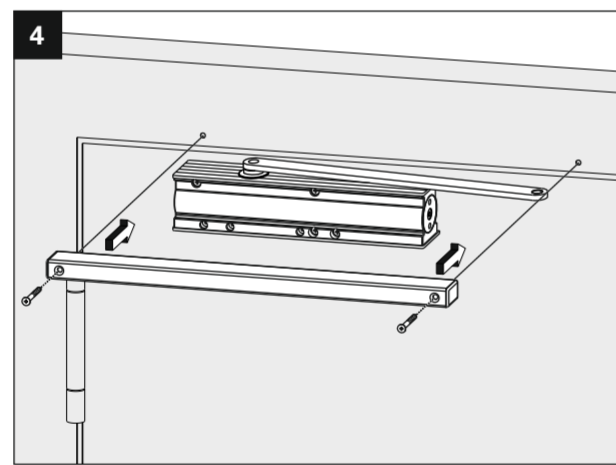
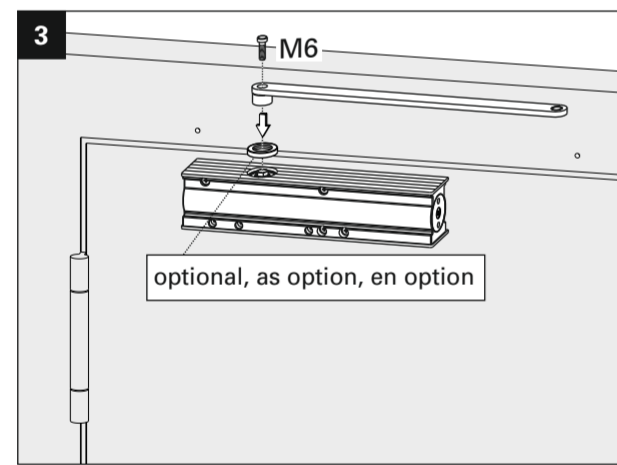
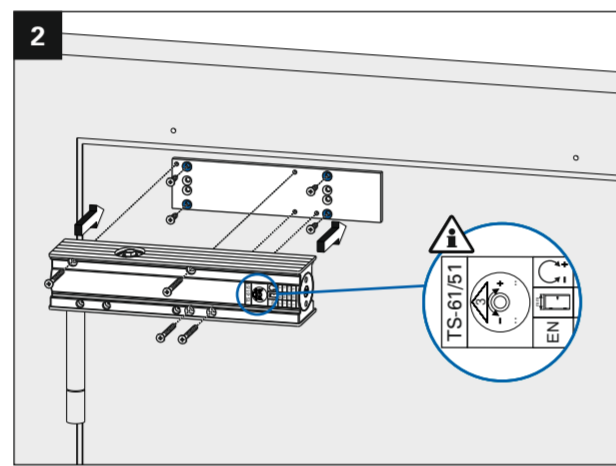
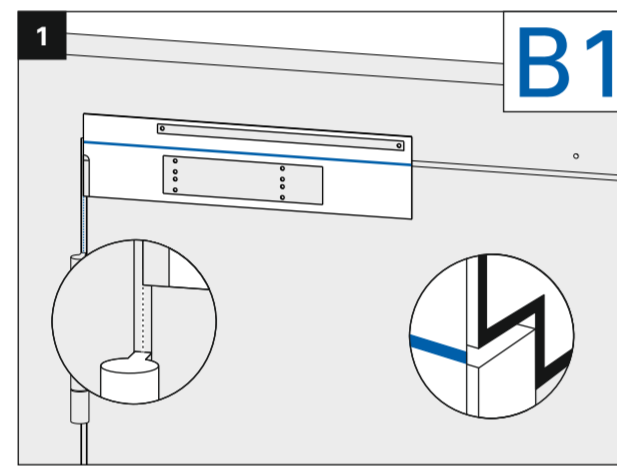

GS B

428,5

120 +/-1

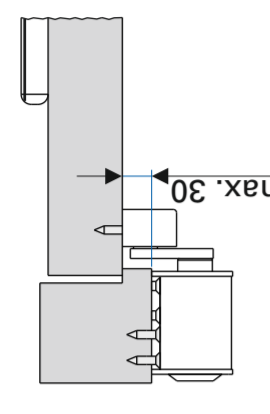
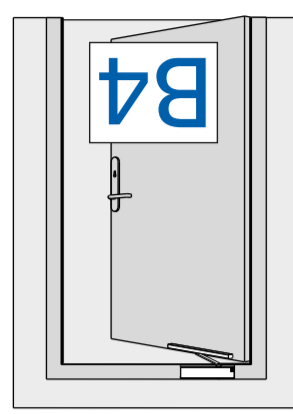

Lochgruppe gemäß Beiblatt 1 zur DIN EN 1154
 Drillings according to supplemental sheet 1 DIN EN 1154
 Alésage selon supplément 1 DIN EN 1154

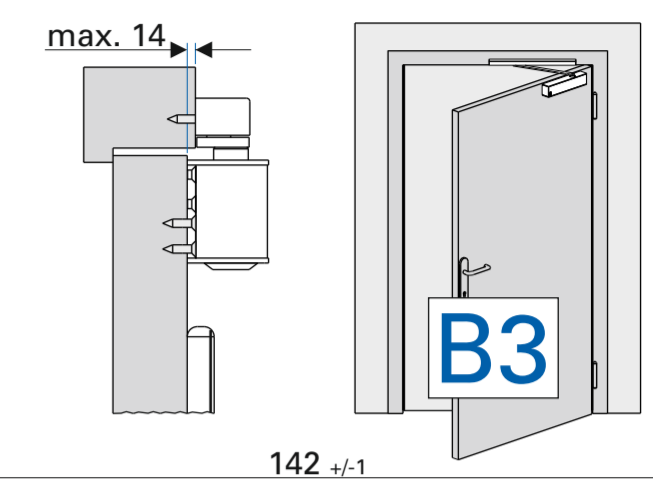
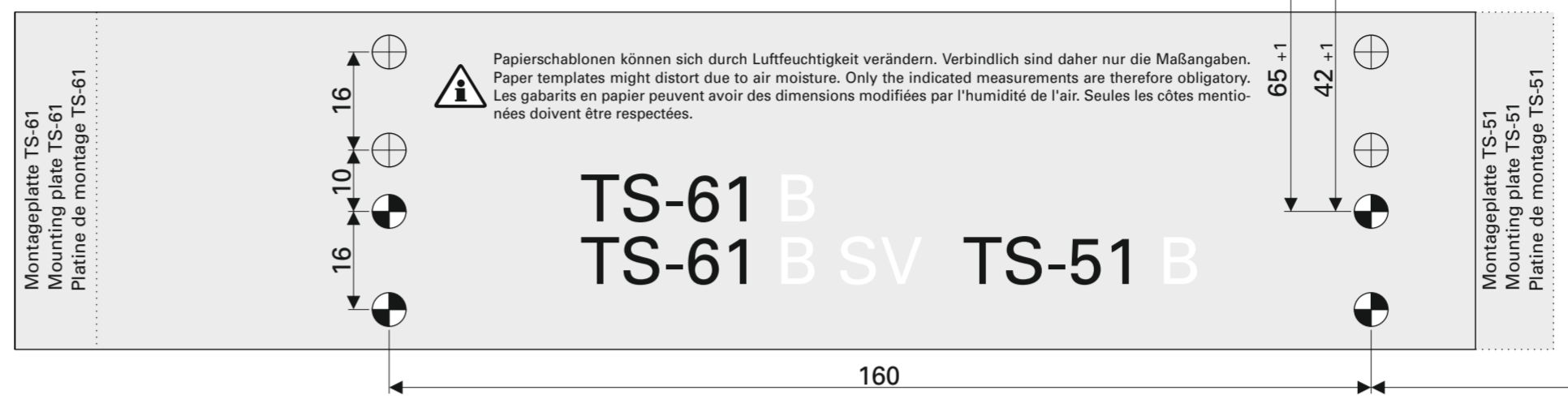

TS-61 B EN 2-5 / 5-6

TS-61 B SV EN 2-5 / 5-6

TS-51 B EN 1-4

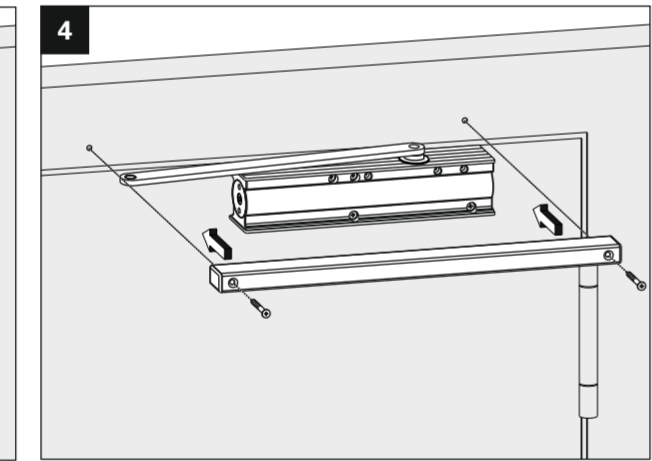
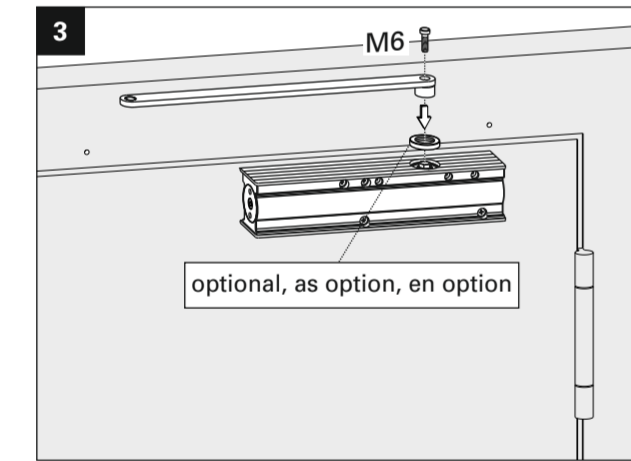
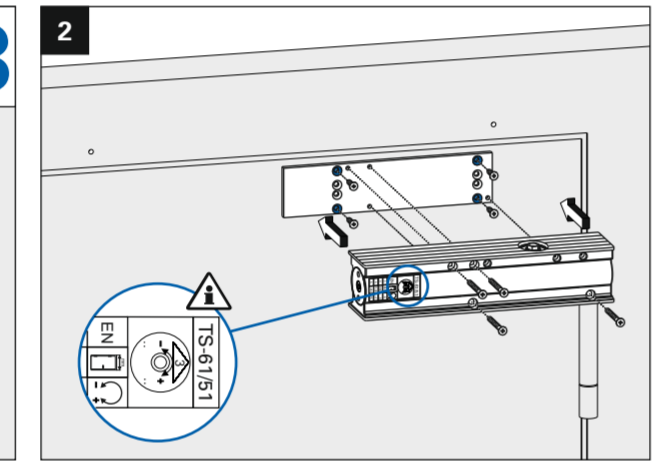
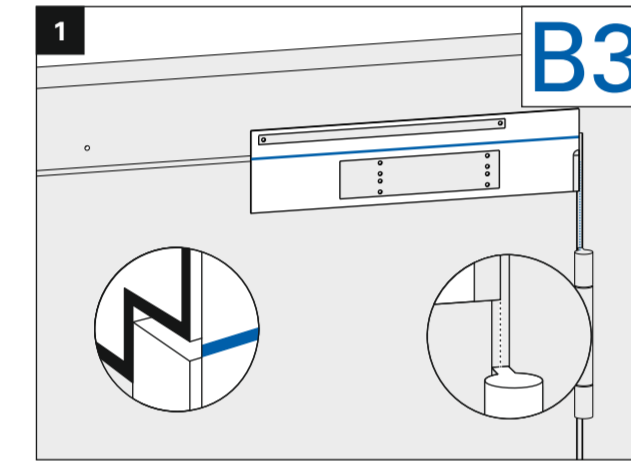

CE	ECO Schulte GmbH & Co. KG Iserlohner Landstraße 117 D-58706 Menden	06
0432 - CPD - 0031	EN 1154:1996+A1:2002 / AC:2006	4 8 1-4 1 1 3 4 8 2-5 1 1 4 4 8 5-6 1 1 4

Türschließergröße Door closer size Force de ferme porte	Max. Türbreite Max. door width Largeur de porte max.	Umdrehungen Rotations Rotations
TS-51 B EN 1-4 #1	750 mm	-7
#2	850 mm	-4
#3	950 mm	0
#4	1100 mm	+6

Türschließergröße Door closer size Force de ferme porte	Max. Türbreite Max. door width Largeur de porte max.	Umdrehungen Rotations Rotations
TS-61 B TS-61 B SV EN 2-5 #2	850 mm	-5
#3	950 mm	0
#4	1100 mm	+7
#5	1250 mm	+15

Türschließergröße Door closer size Force de ferme porte	Max. Türbreite Max. door width Largeur de porte max.	Umdrehungen Rotations Rotations
TS-61 B TS-61 B SV EN 5-6 #5	1250 mm	0
#6	1400 mm	+6

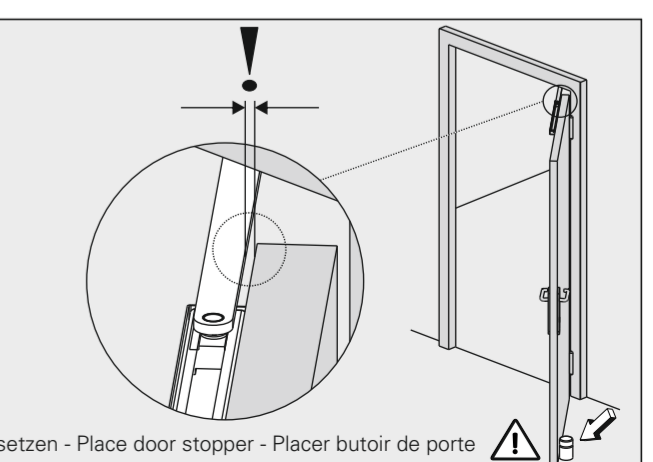
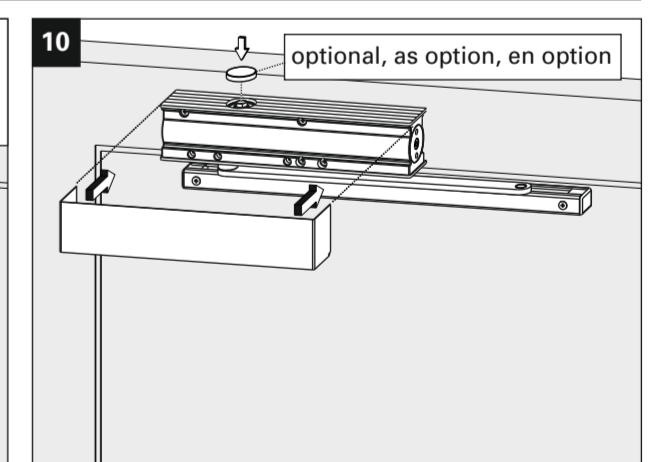
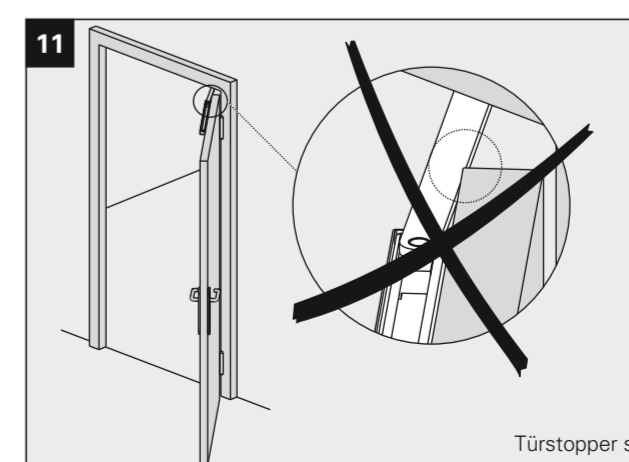
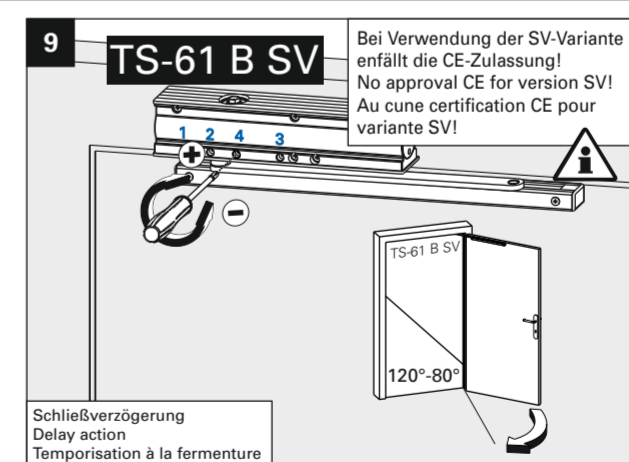
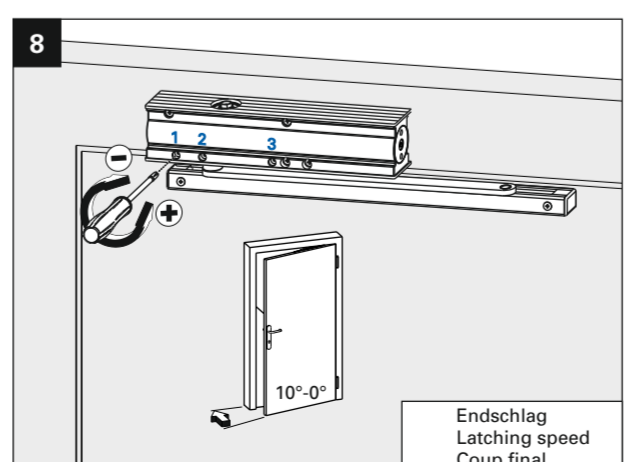
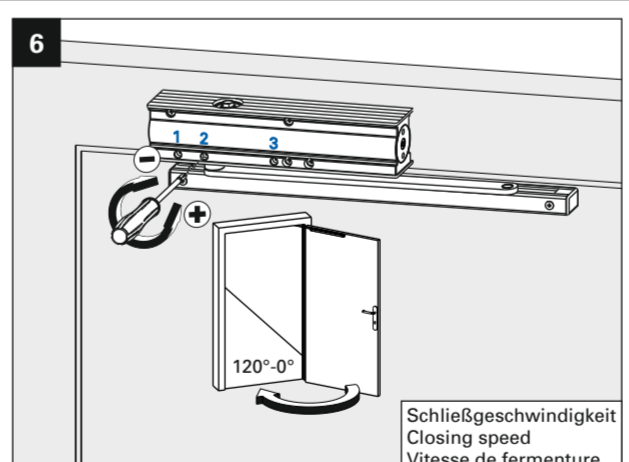
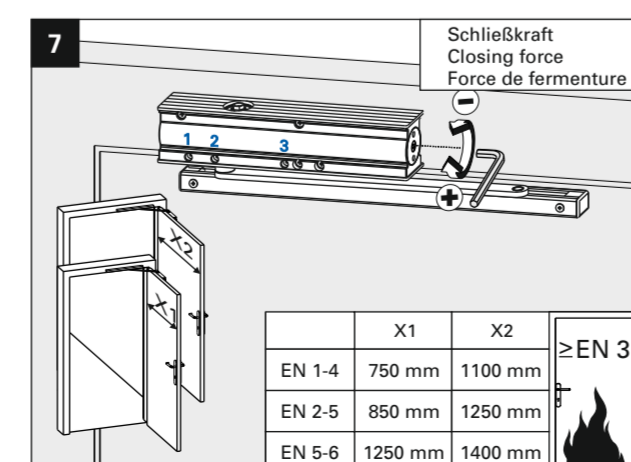
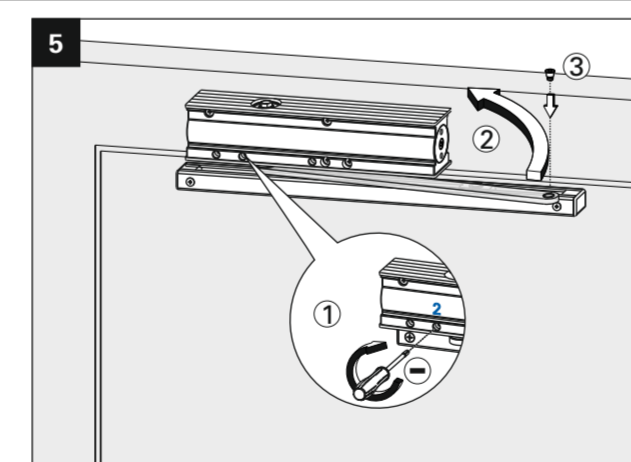
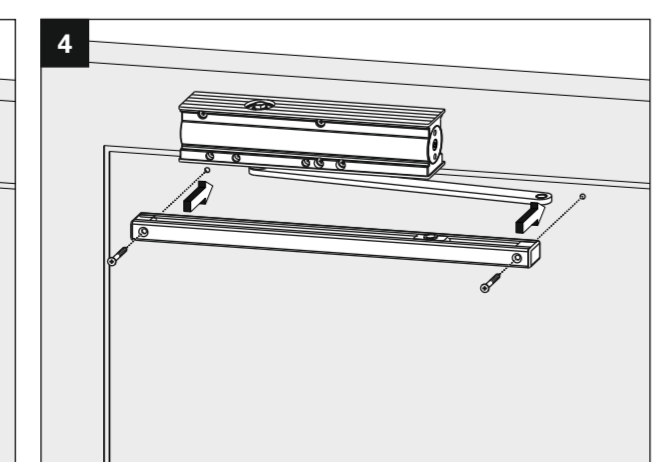
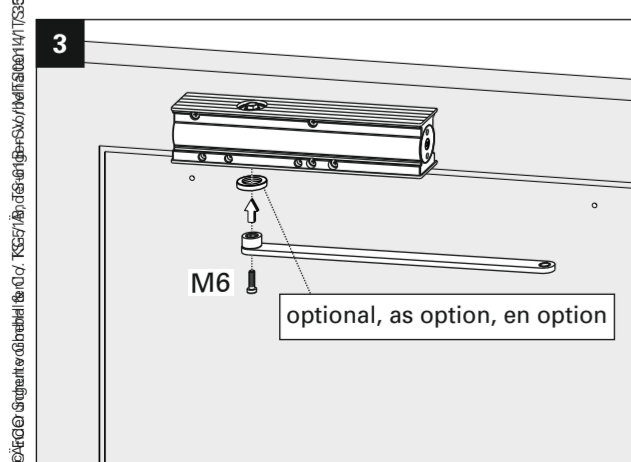
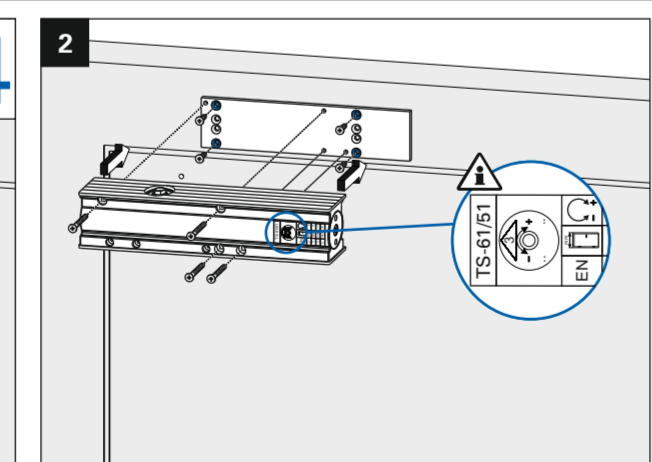
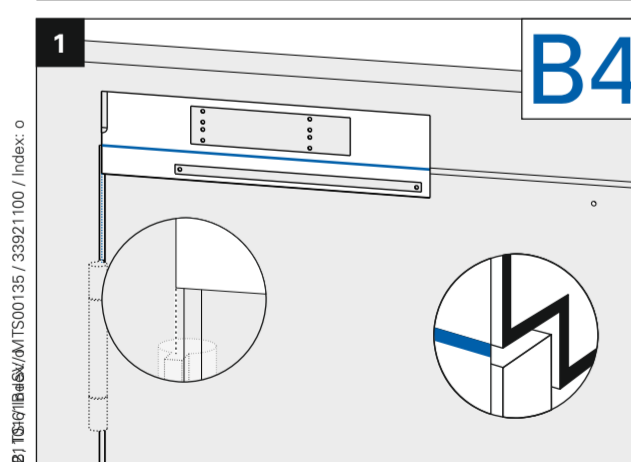
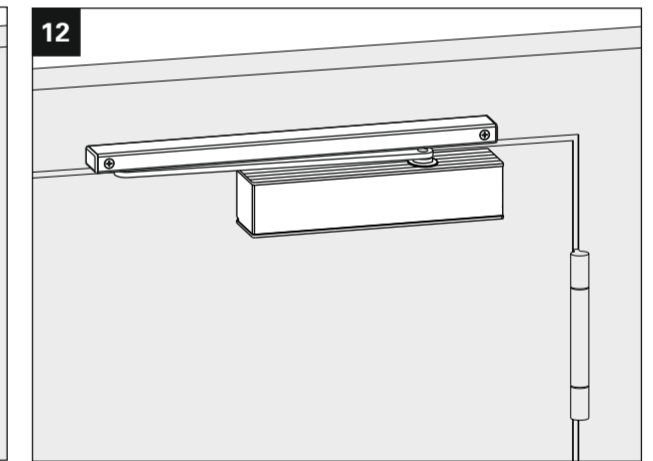
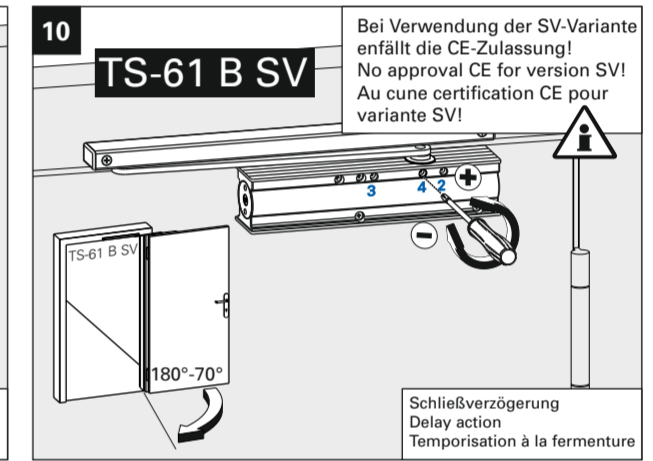
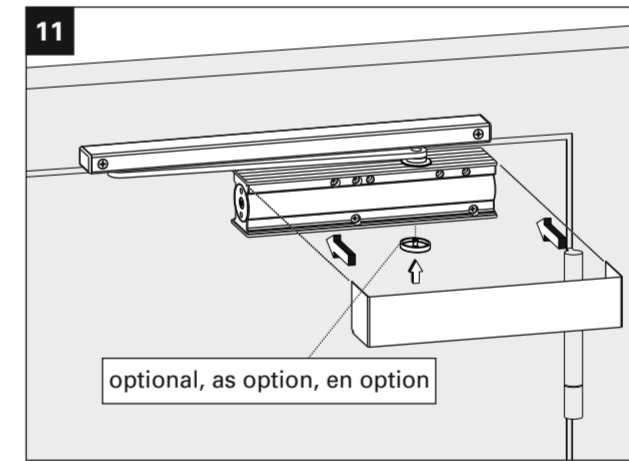
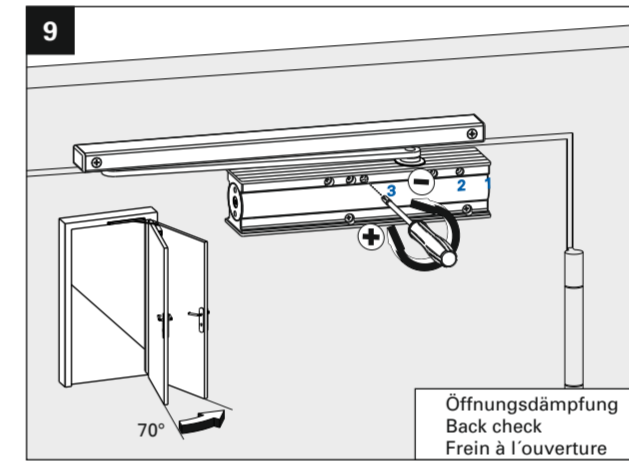
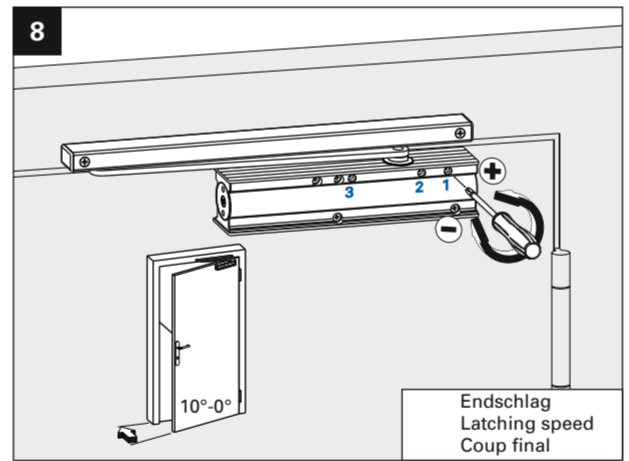
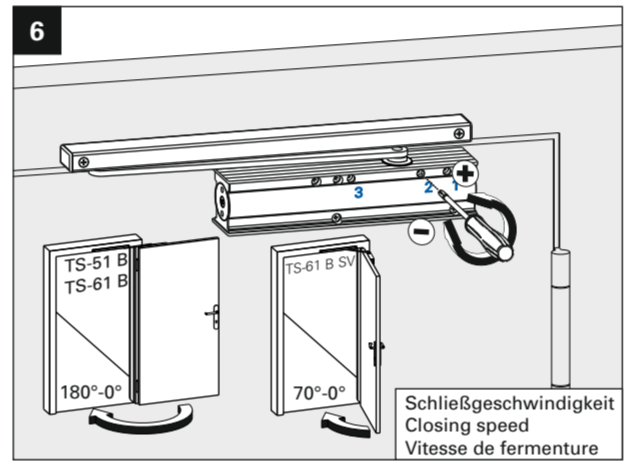
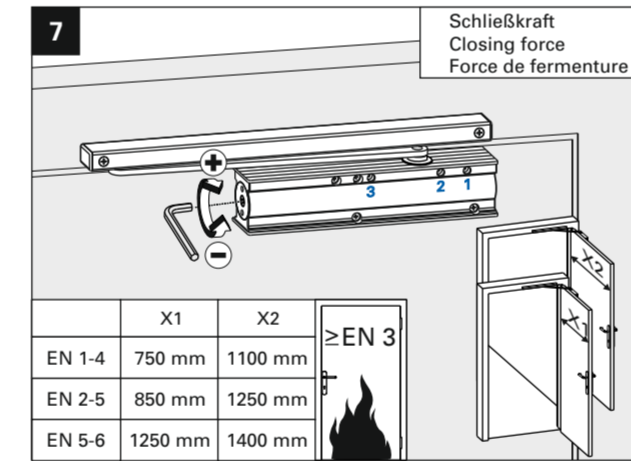
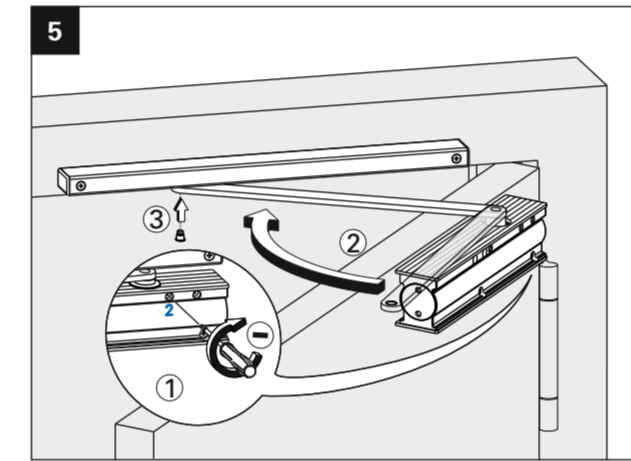

Je nach Türblattstärke und Türbandtyp kann die Winkelabgabe der Schließverzögerung variieren.
 Angle indication of delayed action can be different depending on door thickness and type of hinge.
 L'indication de la temporisation à la fermeture pourra changer selon l'épaisseur de la porte et le type de paumelle.